

Welcome

GJEPC SEZ Members to

An Interactive Meet

7th July 2020

GJEPC SEZ Sub-Committee

Mr. Suvankar Sen, Convener ,

Mr. Bobby Kothari , Co Convener

Mr. Adil Kotwal, Member

Mr. Mehul Vaghani , Member

Mr. Neville Tata, Member

Mr. Rambabu Gupta, Member

Meeting Agenda



- 01 SEZ – 2021-2022 Key Achievements
 - 02 SEZ Policy updates
 - 03 E-Commerce
 - 04 Free Trade Agreements(FTAs)
 - 05 Ongoing/Forthcoming trade shows
 - 06 India Jewellery Park ,Mumbai
 - 07 Members Expectations & Concerns
-

Key Achievements



Infrastructure Projects – Mega CFC	Policy Issues Resolved	Skill Development & Training	Marketing & Promotion
Feasibility study conducted for Mumbai and Surat	Extension of timeline for re-import and return from DTA	CAD Rendering Key shot& V Ray – 4 batches	<ul style="list-style-type: none">• SEZ FOCUS Quarterly Newsletter•
DPR Submitted for SEEPZ to MoC&I	Supply of precious metal to SEZ units procured from FTWZs by Nominated Agencies,	Light Jewellery Making – 1 Batch	<ul style="list-style-type: none">• Dedicated study on USA completed and shared with Indian, Embassy USA•
Foundation stone laying by CIM	Extension of time for re-import of goods sent on consignment by SEZ units	Stamping & Casting – 1 Batch	<ul style="list-style-type: none">• Webinars•
Work on Part – A i.e. construction of Building has started by SEEPZ	Issue of transfer of property in SEZ Increase of tariffs upto 25% by USTR on account of DST	100+ employees from SEZ trained <ul style="list-style-type: none">•	
	Clarification regarding movement of precious metal & other goods of Nominated agency from one SEZ to another SEZ.		

G&J Export Targets & Achievement 2021-2022 US\$million

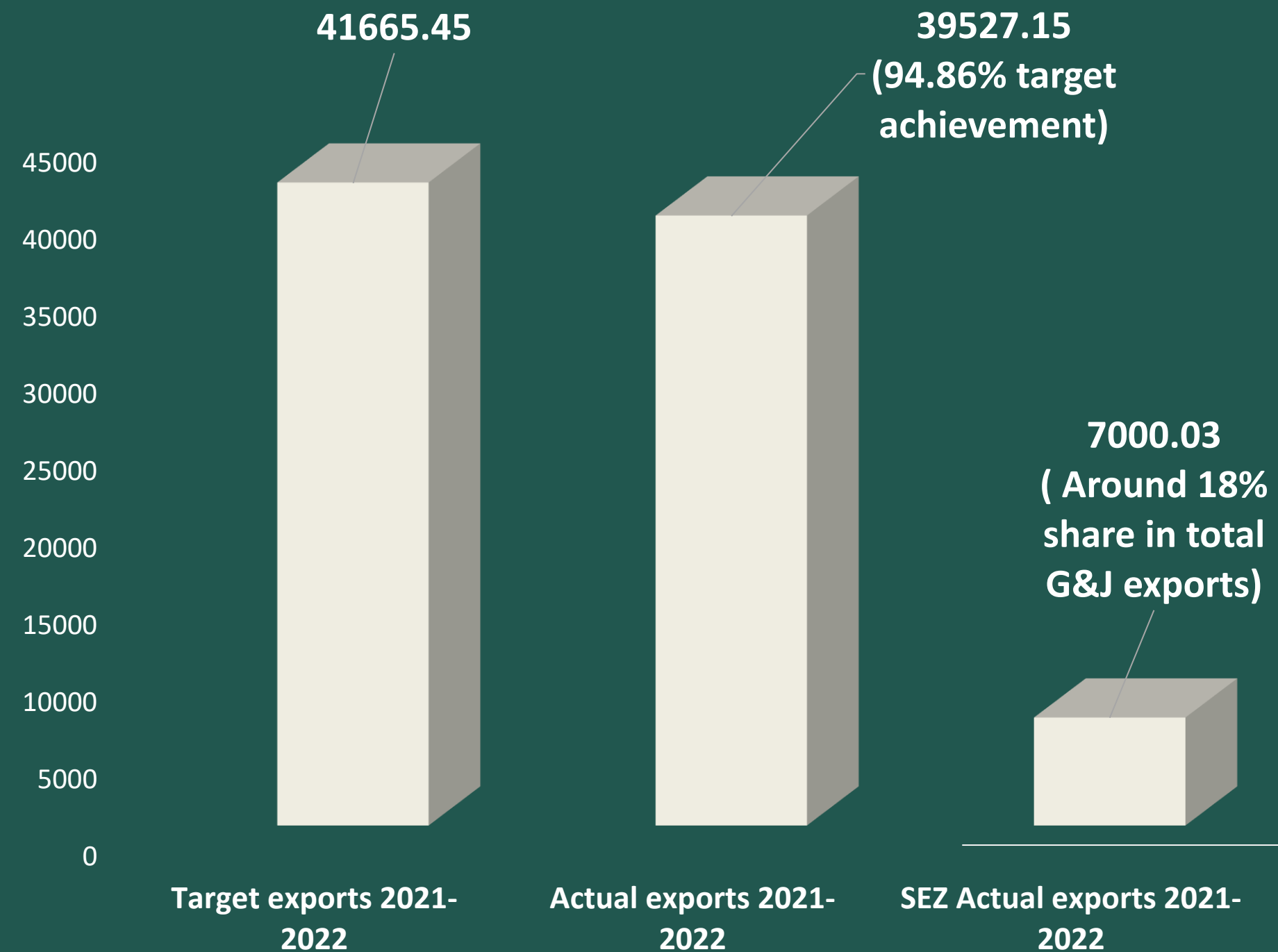

G&J Export Targets & Achievement 2022-2023 US\$million

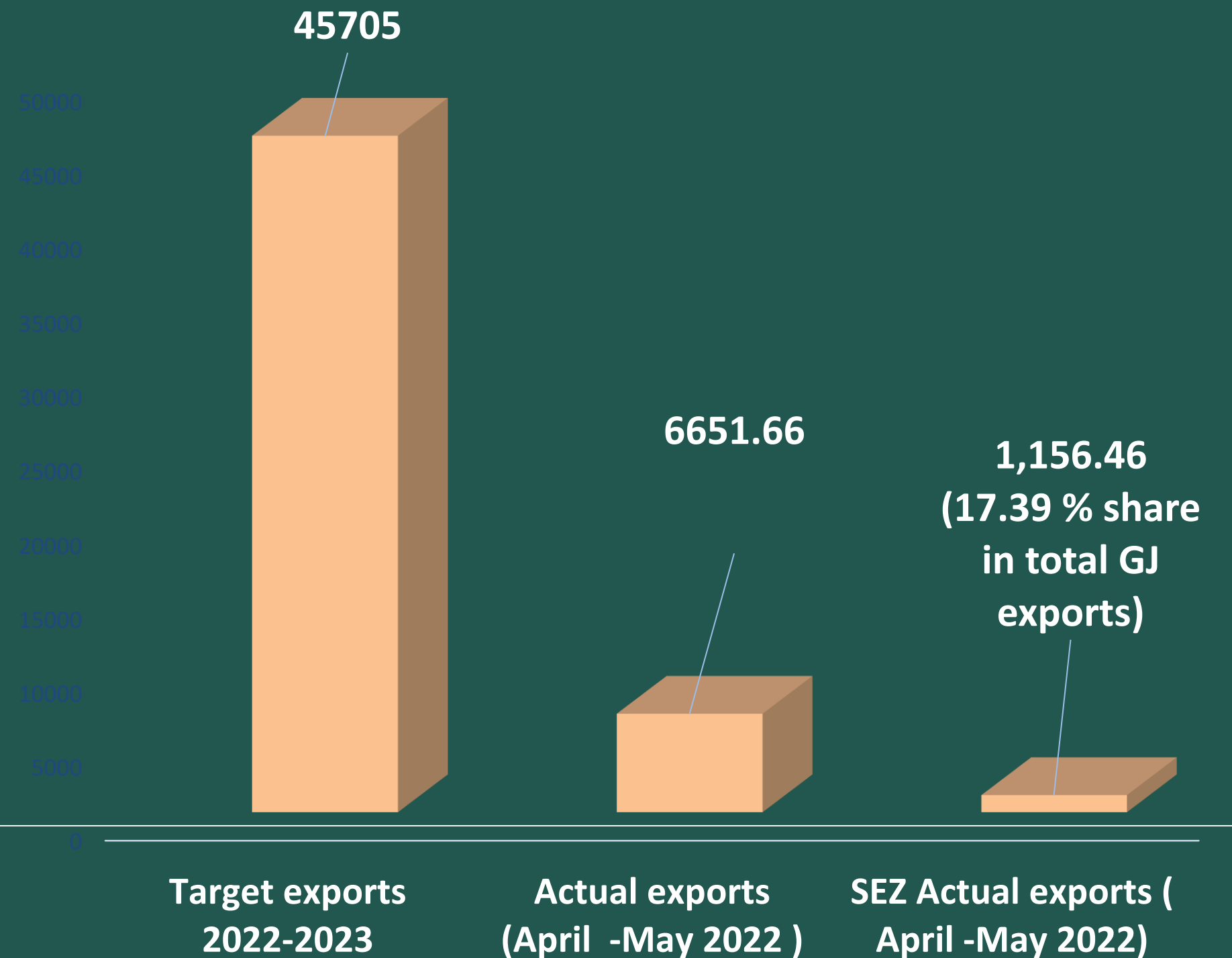



02

Policy Updates

Issues	Update
Determination of RoDTEP rates for SEZs	Under consideration of the concerned department
Allowance of reverse job work policy	Policy expected to be in place in the new SEZ ACT –DESH
Supply of precious metals from foreign buyers to SEZ Units	Represented
Common SOP across Pan - India –SEZs	Represented



Policy Updates w.r.t SEZ ACT

-
1. RULE 41 of SEZ Rules does not allow diamonds having duty to be taken outside SEZ for sub-contracting
 2. There is no provision to send diamonds from SEZ to Special Notified Zone(SNZ) established by the Government of India at Bharat Diamond Bourse, BKC, Mumbai to facilitate imports and trading of rough diamonds in India.
 3. Problems faced by SEEPZ manufacturers regarding Transfer of Property
 4. Request for adding "precious metal" in the notification
 5. All Industry Rate (AIR) to be fixed for SEZ Units to avail Duty Drawback against precious metal supplies received from DTA
 6. SEZ units to be allowed for taking Diamonds & Stones on consignment from DTA at Jaipur
 7. Transfer of precious metal from SEZ to EOUs, Including Silver or Rubber moulds for transfer purpose
 8. Return of non-usable/ rejected pieces of stones
 9. Procurement of 'cut and polished diamonds' from Domestic Tariff Area to SEEPZ-SEZ as 'Bill to Ship to' consignments
 10. Penalties should be based on the amount of default

03



Policy Updates E-Commerce

Central Board of Indirect Taxes and Customs (CBIC) has come up with The Courier Imports and Exports (Electronic Declaration and Processing) Regulations, 2010 which has been suitably amended vide Notification No.57/2022-Customs (N.T.) dated 30.06.2022 and it now incorporates a re-import process for returns of jewellery.

In continuation, CBIC vide Circular No. 09/2022-Customs dated 30th June, 2022 has released the Standard Operating Procedure (SOP) for the facilitation of export of jewellery through e-commerce through courier mode. The jewellery exported through the e-commerce can be executed under CTH 7113 (excluding parts of jewellery falling under CTSH 71131190 and CTSH 71131960) and imitation jewellery falling under CTH 7117 of the First Schedule to the Customs Tariff Act, 1975.

The SOP has been briefed under following heads:

- **Electronic Declaration on ECCS and Uploading of documents.**
- **Producing the goods at the ICT for exports**
- **Customs Assessment and Examination.**
- **Clearance for exports**
- **Procedure for re-import of returned jewellery items**
- **Provision of infrastructure at an ICT for secure handling and movement of jewellery consignment.**
- **Provision of enabling environment by Customs Field Formations.**

04

Free Trade Agreements - FTAs

<div></div> <div>India-UAE CEPA</div>	<div></div> <div>Concluded and Implemented</div>
<div></div> <div>India – Australia ECTA</div>	<div></div> <div>Concluded , yet to implement</div>
<div></div> <div>India - UK</div>	<div></div> <div>On going - Offerings submitted by GJEPC</div>
<div></div> <div>India- EU</div>	<div></div> <div>On going - Offerings submitted by GJEPC</div>
<div></div> <div>India – Canada</div>	<div></div> <div>On going - Offerings submitted by GJEPC</div>
<div></div> <div>India – Israel</div>	<div></div> <div>On going - Offerings submitted by GJEPC</div>

05 Forthcoming Events @GJEPC

Sr.no.	Event list	Dates	Country
1	India Week 2022 DDC New York (Loose Stones - Diamonds, Gemstone, Lab-Grown)	15- 18 August 2022	USA
2	Jewellery and Gem World Singapore 2022	27-30 September 2022	Singapore
3	Vicenza Fall 2022	9-13 September 2022	Italy
4	50th Watch & Jewellery Show, Sharjah 2022	October 2022	UAE
5	International Gem & Jewellery Show (IGJS) Dubai	8-10 November 2022	UAE
6	Jewellery Arabia 2022	22-26 November 2022	Bahrain
7	Vicenza Oro Winter 2023	20-24 January 2023	Italy
8	JGT Dubai 2023	12-14 February 2023	UAE
9	Doha Jewellery & Watches Exhibition 2023	February -2023	Qatar
10	Hong Kong Show 2023	March-2023	Hong Kong

Organised by
GJEPC INDIA

ANNOUNCING THE SECOND EDITION OF

2022 IGJS INTERNATIONAL GEM & JEWELLERY SHOW
DUBAI
08th - 10th November, 2022

THE CURATED GEM & JEWELLERY SHOW



BOOK YOUR BOOTH TODAY!
For Exhibitor Registration, visit: <https://intl.gjepc.org/exhibitor-login>

For further information, contact :-
Mugdha Deshpande: +91 9819101333 | mugdha.deshpande@gjepcindia.com
Daphne D'Costa: +91 9987753810 | daphne.dcosta@gjepcindia.com
Neha Sawant: +91 9821691181 | neha.Sawant@gjepcindia.com

GJEPCIndia | GJEPCIndia | GJEPCIndia

Exclusive Access to India's Best Jewellery in Dubai
Launching



IJEX 2022
India Jewellery Exposition Centre
Dubai, UAE
Business Beyond Borders

A Project of
GJEPC INDIA
Sponsored by the Ministry of Commerce & Industry

In Association with
إيراء دبي ITHRA DUBAI



Forthcoming Events @GJEPC

IIJS Domestic Shows FY 2022-2023

4th to 8th August
2022

IIJS Premiere

Bombay Exhibition Centre, Nesco
Mumbai

5th to 8th January
2023

IIJS Signature

Bombay Exhibition Centre, Nesco
Mumbai

17th to 20th March
2023

IIJS Tiritiya

Bengaluru International Exhibition Centre
Bengaluru

Phase wise Visitor Registration Charges

Visitor Category	Phase 1 2nd May - 20th Jun 2022	Phase 2 21st Jun- 2nd Aug 2022	Phase 3 3rd Aug - 8th Aug 2022
Members	INR. 2000	INR. 3500	INR. 6500
Non-Members	INR. 2500	INR. 4500	INR. 8500

For Visitor Registration, log on to,
https://registration.gjepc.org/single_visitor.php

IIJS. WHERE BUSINESS HAPPENS.



India Jewellery Park Mumbai

Discussion Document

Jul' 22

Vision for IJPM – Unlocking India's Potential

To develop a world-class Jewellery Park to enhance our global competitiveness and contribute towards the development of Maharashtra and India by attracting an investment of over Rs.14,000 crore and generate employment opportunities for more than 1 lakh people

Derived by the thought process in Turkey, China, Hong Kong, Dubai, Thailand, etc. to have an integrated Jewellery Park to facilitate trade

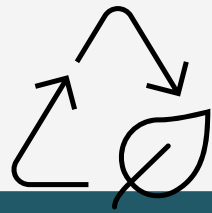

1

Create an end-to-end jewellery manufacturing ecosystem under one roof – security, logistics, refinery, machinery, etc.

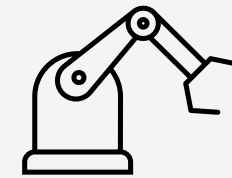

2

Provide state-of-the-art infrastructure with all ancillary facilities, a skilled workforce and a conducive business environment to manufacturers

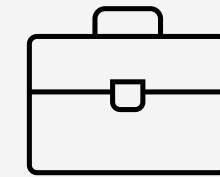

3

Support MSMEs to create more job opportunities in the employment-intensive gems and jewellery sector

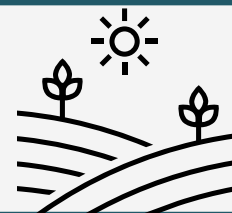

4

To improve the living standards of Karigars and develop interest among the next generation of such workers

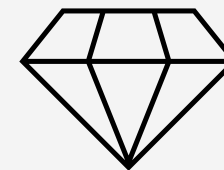

5

To promote local and handmade jewellery

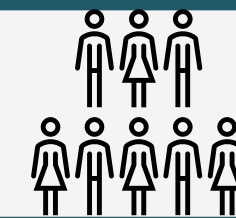

6

Organizing the currently unorganized gems and jewellery sector in India

Introduction to IJPM

India Jewellery Park Mumbai (IJPM) is GJEPC's ambitious project to provide state-of-the-art facilities to manufacturers and bring entire Jewellery manufacturing ecosystem under one roof. The project is envisaged to house more than 1000 Gems and Jewellery units on 21.3-acre plot of land.

Building A



- Block A is “State of the art” manufacturing facility for **Large** and **Medium** manufacturers
- Industrial units from **2,672** sq. ft. to **5,273** sq. ft. carpet area with total of **23 Lac+** area available
- This block will have 9 interconnected buildings of ground + **14** floors

Building B



- Block B is manufacturing facility for **Small Unit Holders** and **Karigars**
- Industrial units from **413** sq. ft. to **621** sq. ft. carpet area with total of **3 Lac+** area available
- This block will have one building of ground + **9** floors

Conceptual Master Plan

Unit Type	Building Block	No of Units	RERA Carpet (Saleable Area) Sq. Ft.
Karkhana Type 1	A	190	5,273
Karkhana Type 2	A	190	4,429
Karkhana Type 3	A	76	3,550
Karkhana Type 4	A	76	2,672
Karkhana Type 5 (small)	B	294	621
Karkhana Type 6 (small)	B	280	413
		1,106	

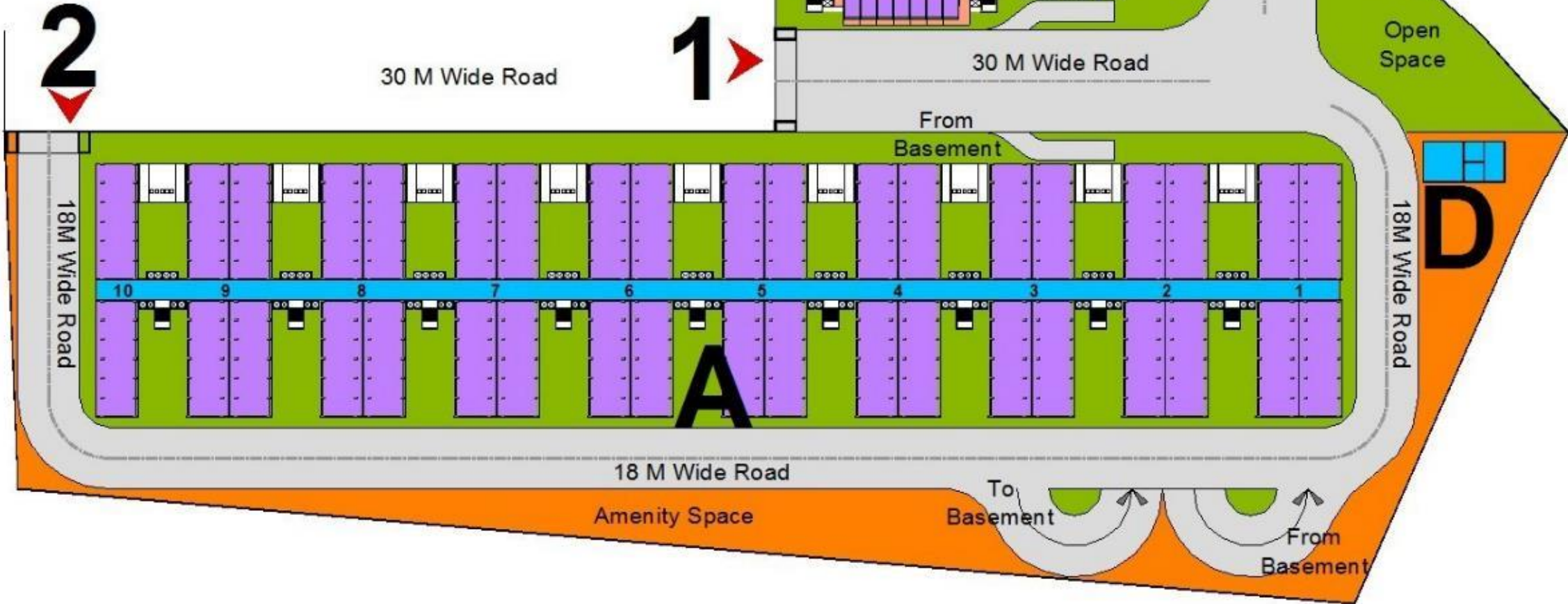

IJPM - Location



Zaveri Bazaar to IJPM ~50 mins only



Upcoming Mumbai Airport ~30 mins only



Koparkhairane Station ~10 mins only



IJPM to Vashi Toll Naka ~20 mins only

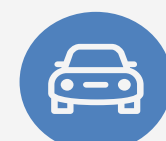

IJPM to IKEA ~10 mins only

Salient Features of IJP

Economic Benefits

- **Single Window Clearance** for government approvals under Maitri Policy
- Exemptions of **property tax** ⁽¹⁾
- Applied for granting **Ultra Mega Status** to IJP for providing waiver of **electricity duty, power tariff** ⁽¹⁾
- **Reimbursements** of 100% of **stamp duty** & allied charges ⁽²⁾
- **Competitive pricing** since project undertaken by Council for members

State-of-the-art Facilities

- **Shared common facilities** – ETP, STP, Common air-handling gas chamber, Emergency power back-up, etc.
- Advanced **Security & Safety** Features (End-to-end camera surveillance)
- **CFC** for ancillary services like electroplating, sire assaying, 3D metal printing, etc.
- **Multipurpose halls** for facilitating buyer - seller meets
- **14 ft.+ height** with Tremix flooring
- Construction by a leading **tier-A EPC firm**
- Car **parking** as per MIDC norms with ample **guest parking**

Karigar Wellbeing

- **Low-cost residential facilities** for workers in the vicinity
- **Training & Upskilling facilities** for karigars & technicians incl. regular courses
- **Health & fitness facilities** for Karigars – basketball court, cricket ground, TT, etc.
- Ample **Bike and bicycle parking** for Karigars

Government Support

- **MoU for direct leasing signed with MIDC and first instalment** already paid
- Working with **State Government** for granting Ultra Mega Status to IJP
- CM's vision to create "iconic" structure

Other Benefits

- **Value added services** like Legal consultation, Financing facilitation, Construction consultation
- **Iconic architecture** with landscaped terrace gardens
- Development of nearby Lake
- **Resources on call – karigars availability**

End-to-end Ecosystem

- Housing **sourcing offices** of large **retailers**
- **Financial institutions** like **Banks, Customs office**
- **Refreshment & lifestyle facilities** like canteens, fitness centers, recreational area, etc.

(1) Working with State Government

(2) Proposed to State Government

Block A Details and Payment Schedule

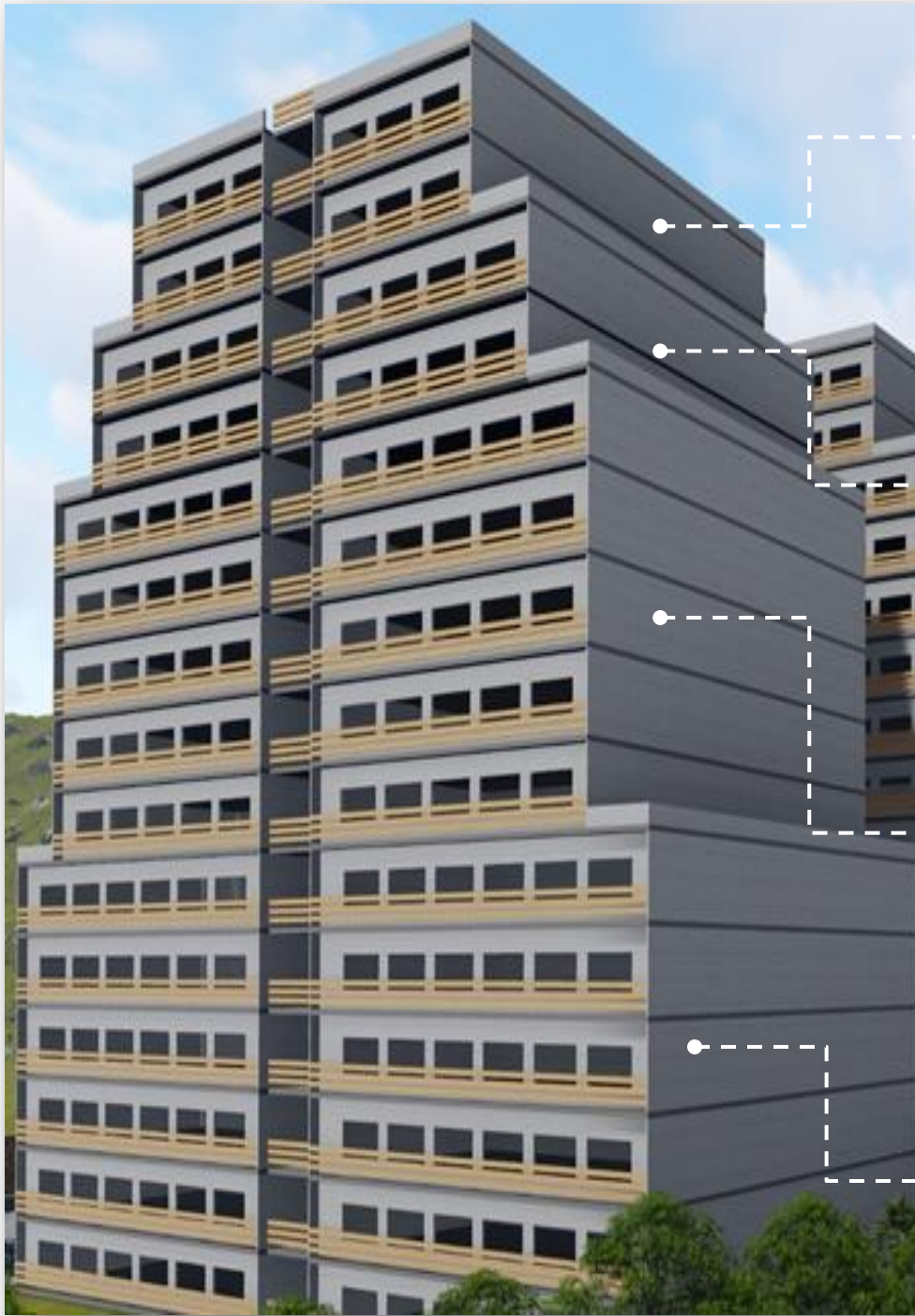

Unit	# Units	Sq.- Ft.	Rate*
13 th to 14 th Floor Karkhana Type 4	76 Units	2,672 Sq. Ft.	INR 7,100 per Sq. Ft.
11 th to 12 th Floor Karkhana Type 3	76 Units	3,550 Sq. Ft.	
6 th to 10 th Floor Karkhana Type 2	190 Units	4,429 Sq. Ft.	INR 7,250 per Sq. Ft.
1 st to 5 th Floor Karkhana Type 1	190 Units	5,273 Sq. Ft.	INR 7,400 per Sq. Ft.

Payment Schedule – Construction Liked Payment	
10%	On Booking
5%	On Registration
15%	Plinth
12%	Slab Work 1
12%	Slab Work 2
12%	Slab Work 3
12%	Structure & Plaster Flooring etc.
12%	Electric Work, Plumbing, tiling etc.
10%	Possession

- Note:**
- 1. All rates in RERA carpet area rates
 - 2. All rates exclusive of GST & taxes
 - 3. Facilities and area may be subject to change
 - 4. *The rates are indicative and may vary during the time of booking

Contact Details

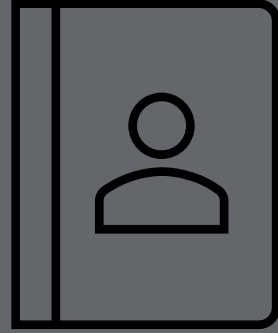

Contact Us

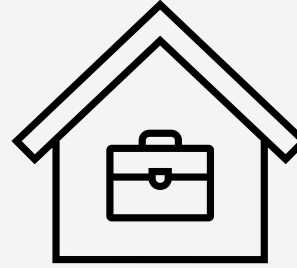

Office Address: India Jewellery Park, Mumbai
C/o THE GEM & JEWELLERY EXPORT PROMOTION COUNCIL
D2B, D-Tower, West Core Wing,
Bharat Diamond Bourse,
Bandra Kurla Complex,
Bandra (E), Mumbai - 400 051
Maharashtra, India

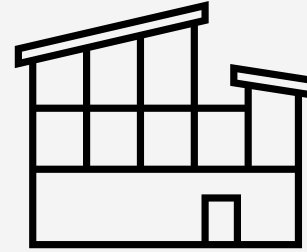

Site Address: India Jewellery Park, Mumbai
Plot No. EL 237, TTC Industrial Area,
Mahape Navi Mumbai,
Maharashtra - 400 705



Toll Free Number:
1800-103-4353
Missed Call Number:
+91-7208048100

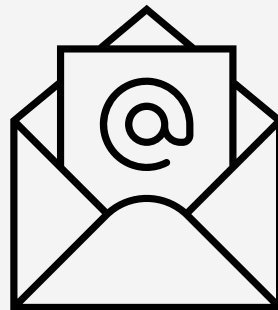

Email: info@jewellerypark.org

07

Members' Concerns & Suggestions

We thank you for
your continued
Cooperation and
feedback in our
efforts to contribute
to SEZ related
work
